

KOINE'

design Mandalaki

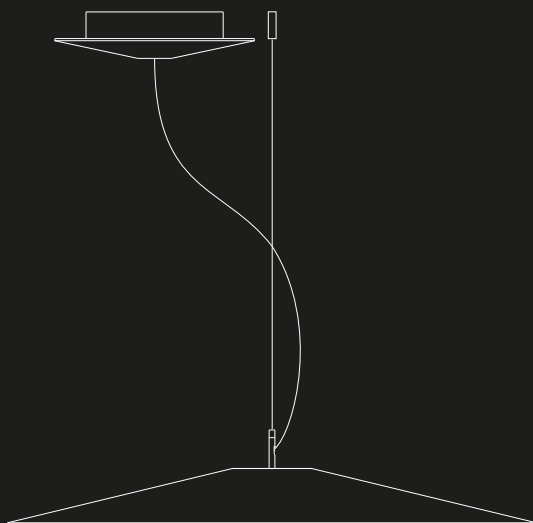

**LUCE
PLAN**

A07



A07/1D
A07/1T
A07/2D
A07/2T

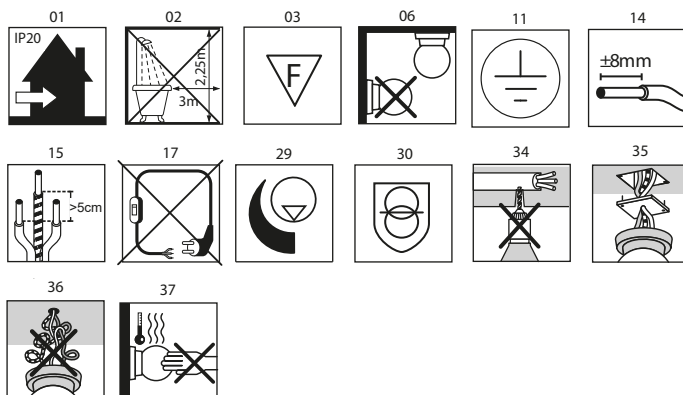

A07S37W
A07S55W
A07S11W

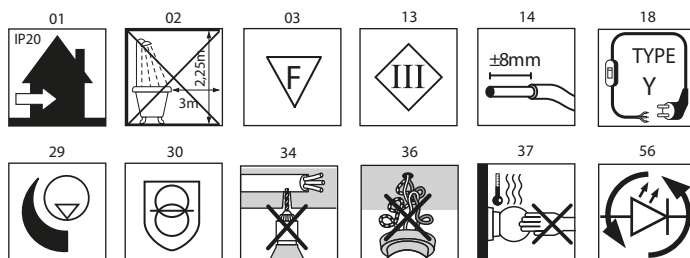

A07S37
A07S55
A07S11

A07F86W
A07F11W

A07F86
A07F11

Iin: 500mA - 750mA (pag.3)

Vin: Max 60 Vdc SELV



Il prodotto NON deve essere collegato direttamente alla tensione di rete.
Utilizzare la adeguata unita di alimentazione!

The product must NOT be connected directly to the mains voltage.
Use the appropriate power supply unit.

Das Produkt darf nicht an die Netzspannung direkt angeschlossen werden.

Le produit NE DOIT PAS être connecté directement a la réseau électrique.
Utilisez la correcte alimentation électrique.

El producto no debe ser conectado directamente a la red eléctrica.
Utilice la fuente de alimentación correcta.

A07/1D

A07/1T

A07/2D

A07/2T



1x



A07S37W max 500mA

A07S55W max 500mA

A07S11W max 750mA

A07S37 max 500mA

A07S55 max 500mA

A07S11 max 750mA

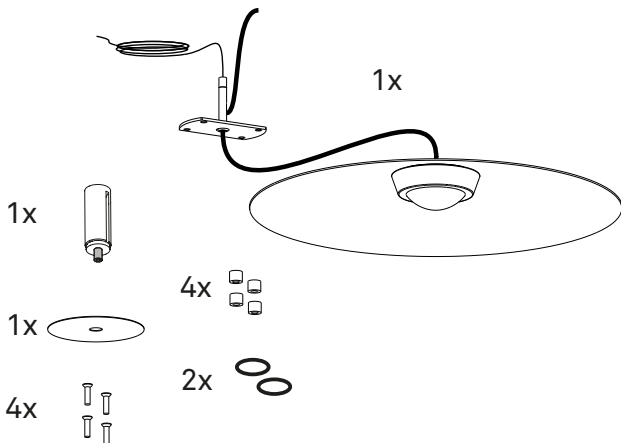

A07F86W max 500mA

A07F11W max 700mA

A07F86 max 500mA

A07F11 max 700mA

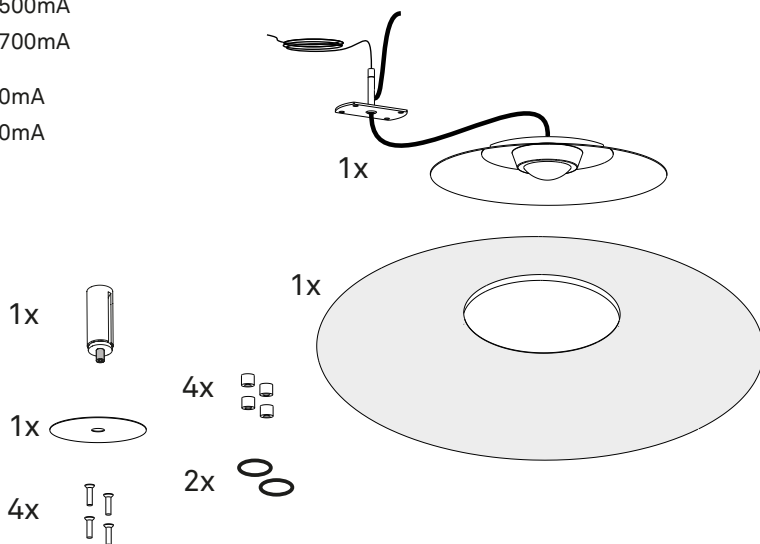

A07/1D

A07/1T

A07/2D

A07/2T

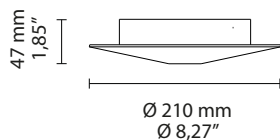

kg 0,5kg **lb** 1,1lbs

A07S37W

A07S37

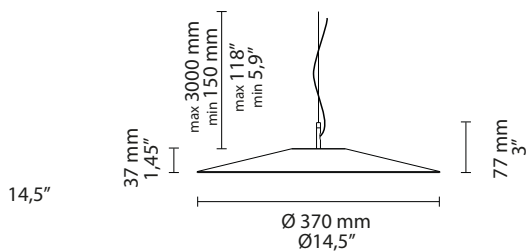

kg 0,8kg **lb** 1,8lbs

A07S55W

A07S55

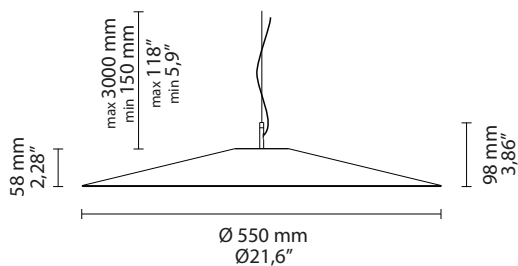

kg 1,3kg **lb** 2,9lbs

A07S11W
A07S11

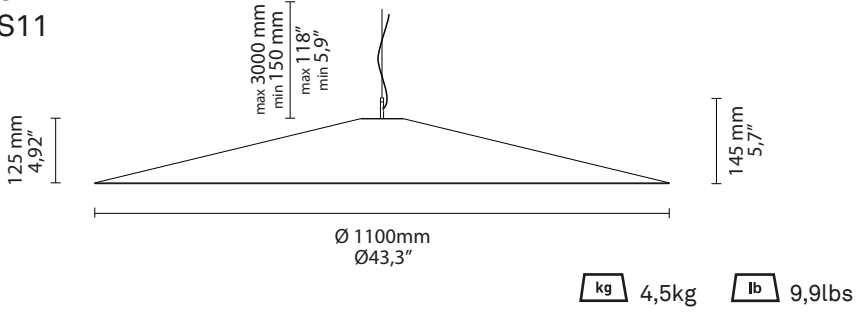

A07F86W
A07F86

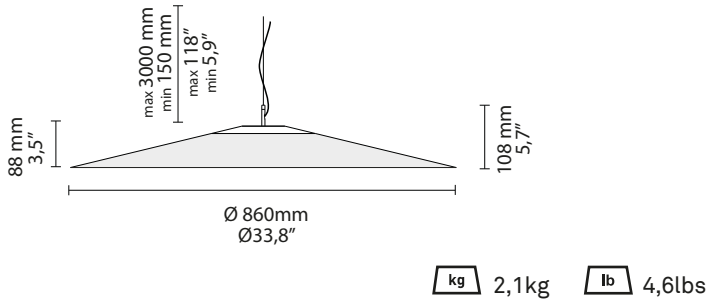

A07F11W
A07F11

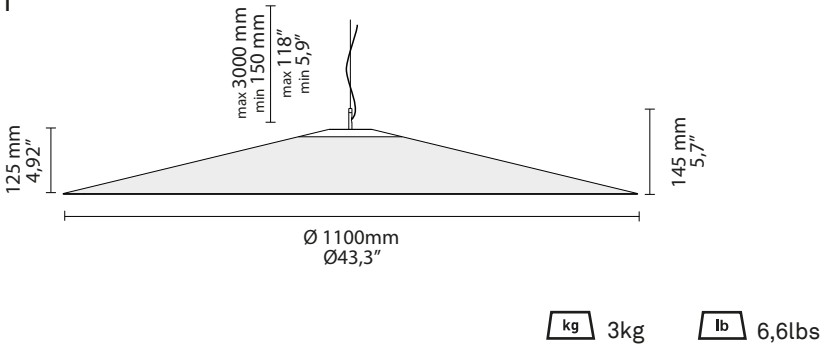

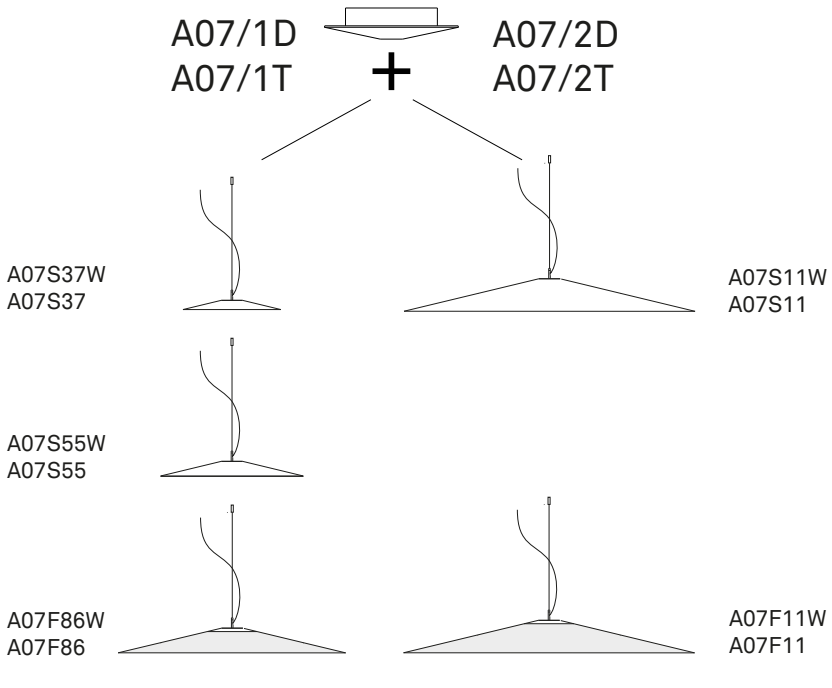

remote
LED driver

I_{out}: max 500mA_{dc}
V_{out}: max 60 V_{dc}
SELV

I_{out}: max 750mA_{dc}
V_{out}: max 60 V_{dc}
SELV

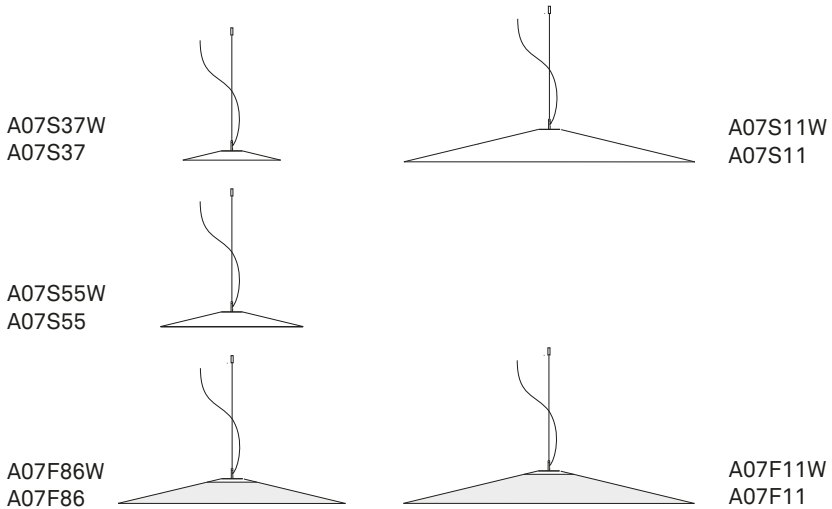



A07/1D
A07/2D

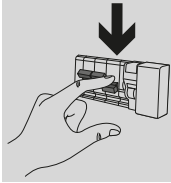

1

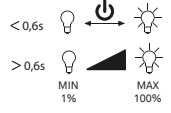
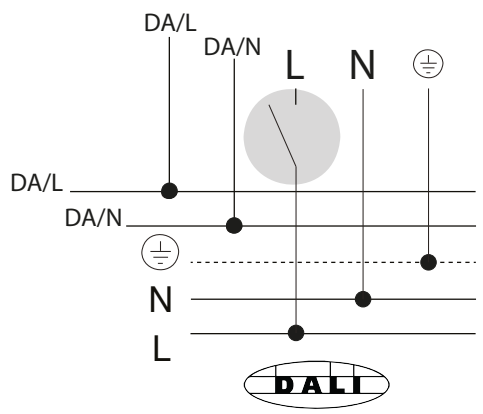
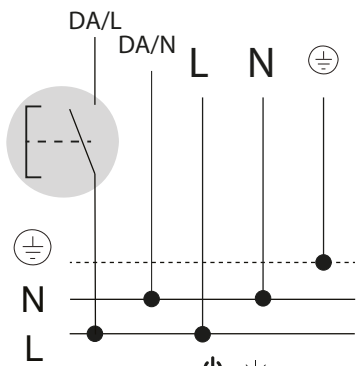
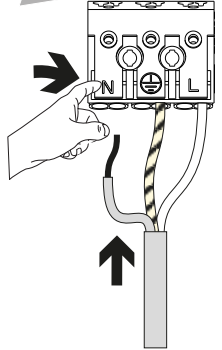
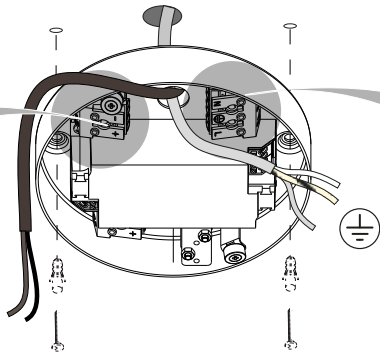
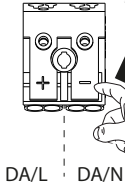
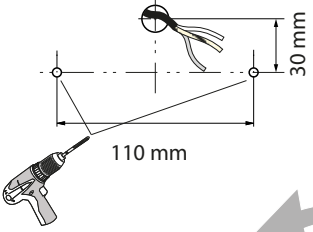
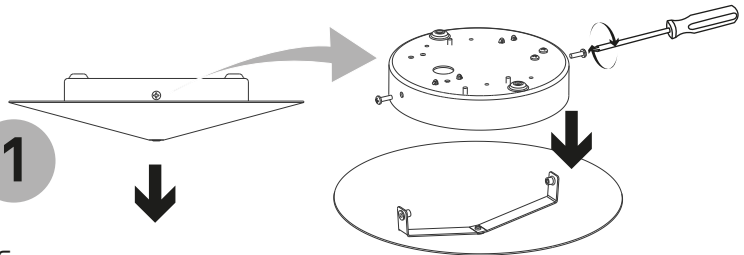

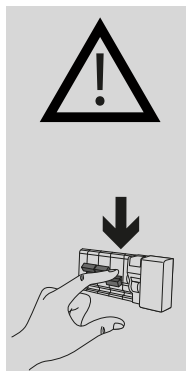

A07/1T
A07/2T

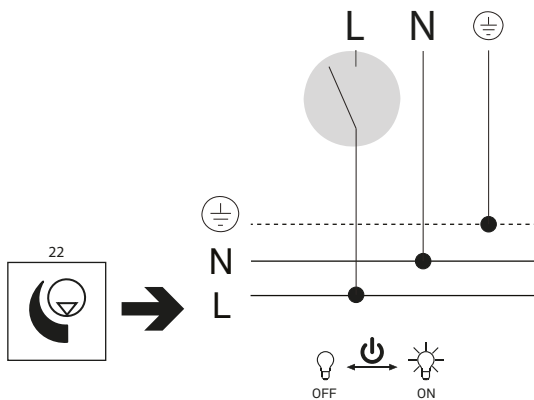
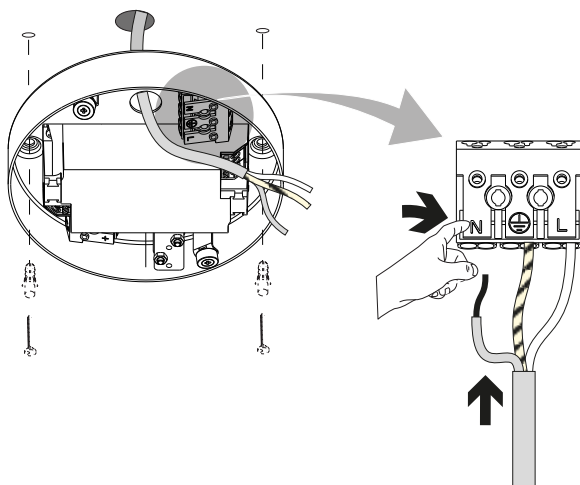
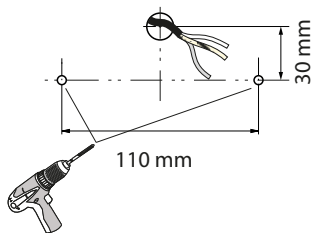
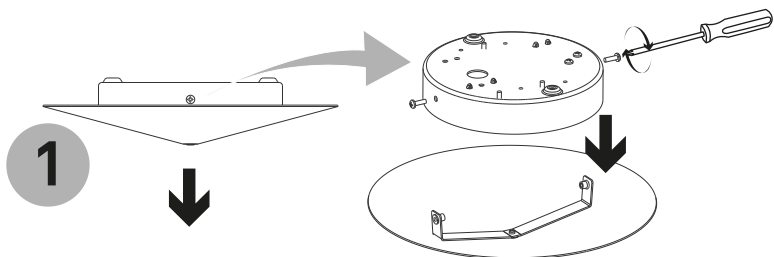

A07S37W
A07S55W
A07S11W

A07S37
A07S55
A07S11

A07F86W
A07F11W

A07F86
A07F11

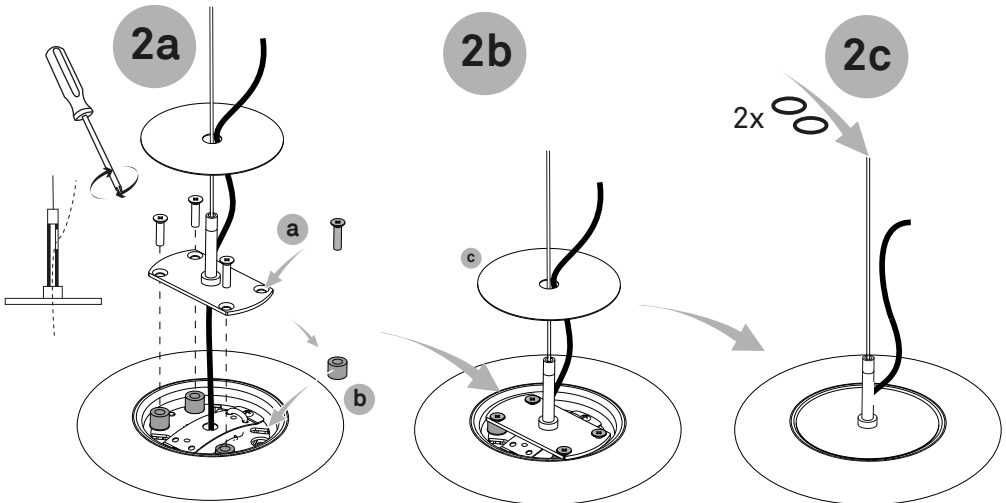
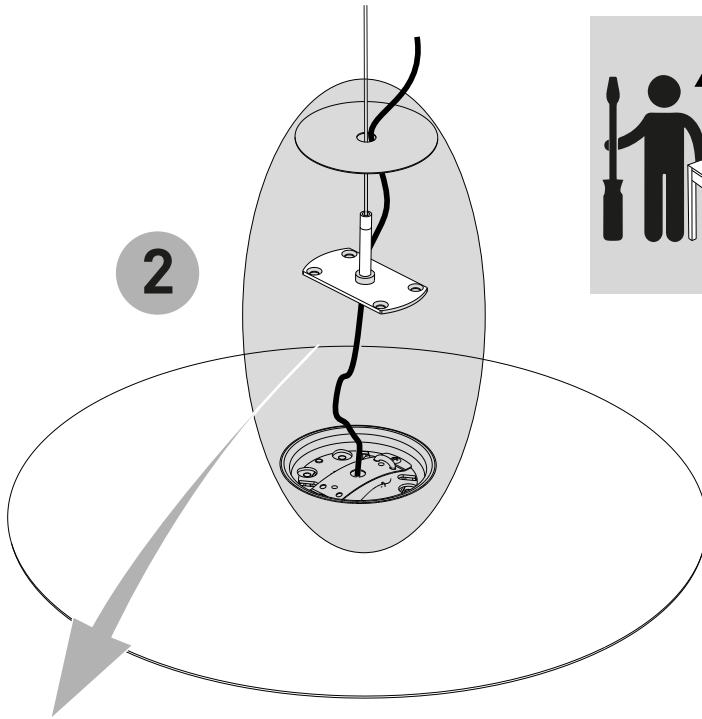
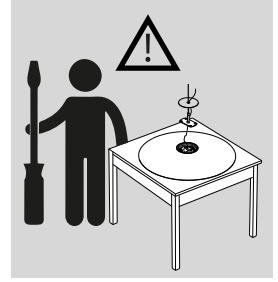

A07F86W

A07F11W

A07F86

A07F11

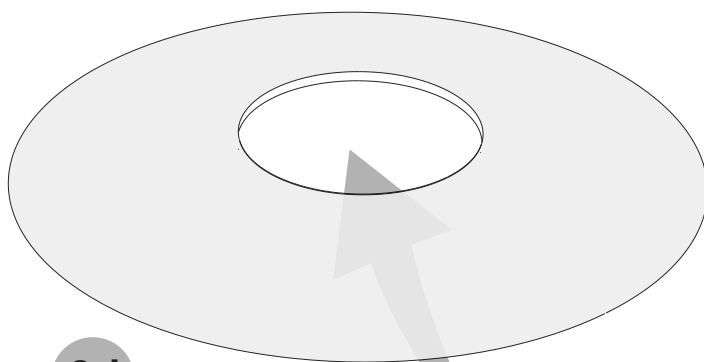

2d

Inserire il corpo led nell'elemento fonoassorbente prima di cablare al rosone.

Insert the LED body into the sound-absorbing element before wiring the ceiling rose.

Setzen Sie den LED-Körper in das schallabsorbierende Element ein, bevor Sie ihn mit dem Deckenbaldachin verkabeln

Insérez le LED dans l'élément insonorisant avant le câblage à la rosace de plafond

Introduzca el cuerpo del LED en el elemento fonoabsorbente antes de cablearlo en el rosetón.

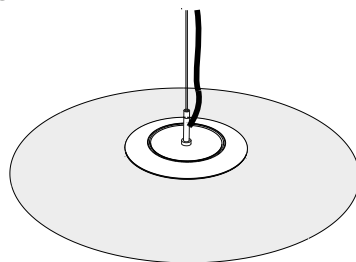
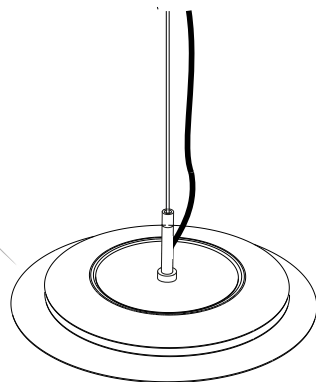

A07S37W
A07S55W
A07S11W

A07S37
A07S55
A07S11

A07F86W
A07F11W

A07F86
A07F11

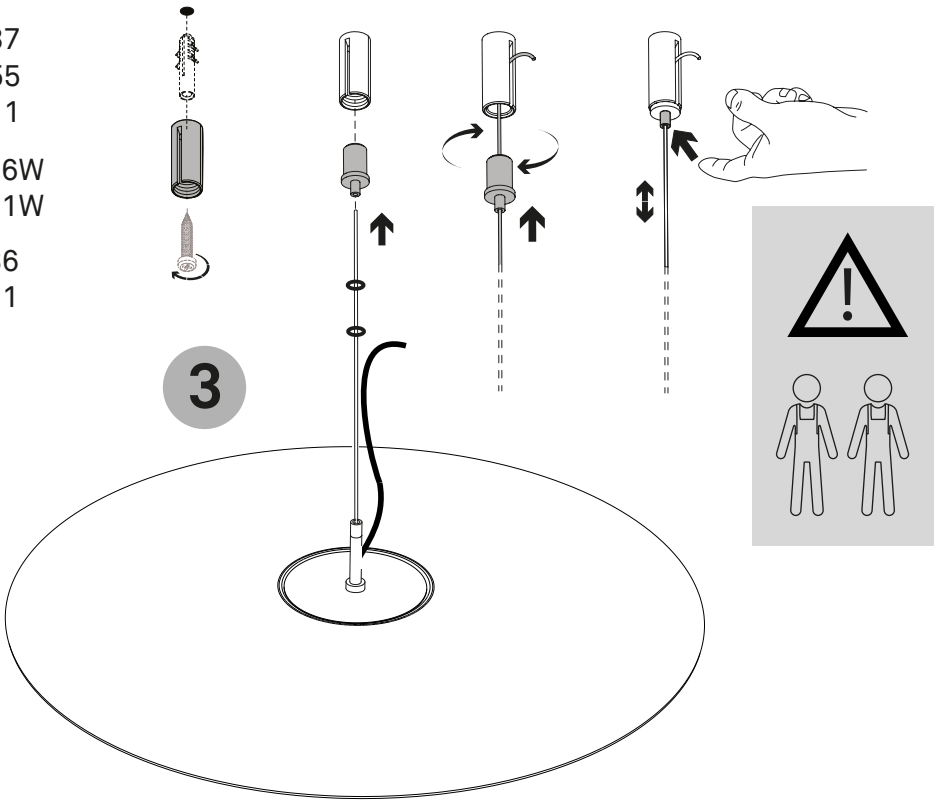

Regolare l'altezza di installazione (L) prima di effettuare il collegamento elettrico.

Adjust the installation height (L) before making the electrical connection

Passen Sie die Installationshöhe (L) an bevor Sie den elektrischen Anschluss vornehmen

Règlez l'hauteur d'installation (L) avant d'effectuer le raccordement électrique

Ajuste la altura de instalación (L) antes de realizar la conexión eléctrica

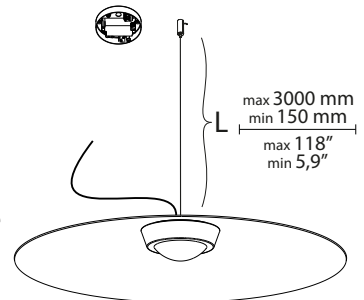

A07S37W
A07S55W
A07S11W

A07S37
A07S55
A07S11

A07F86W
A07F11W

A07F86
A07F11

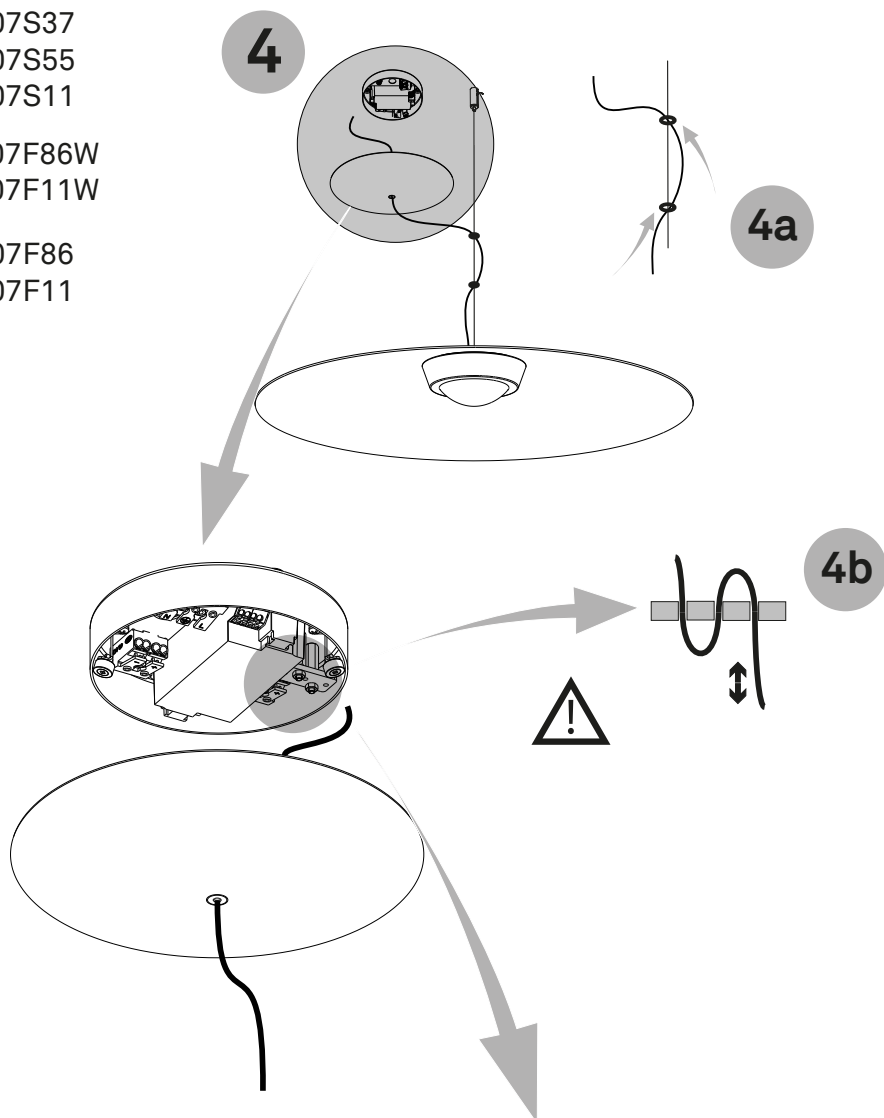

4C

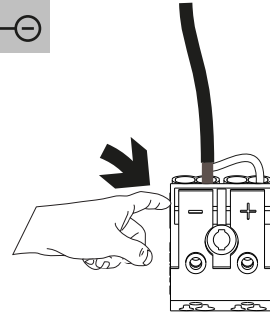
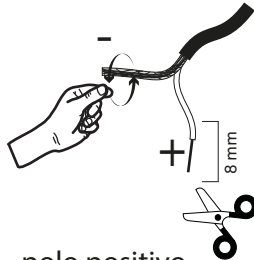
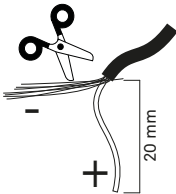
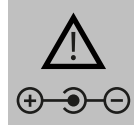
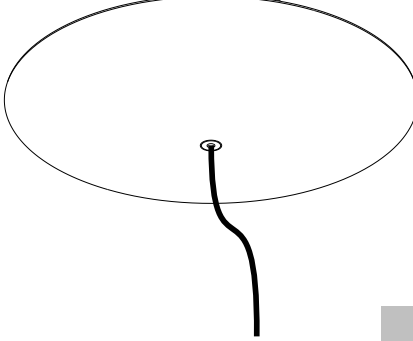
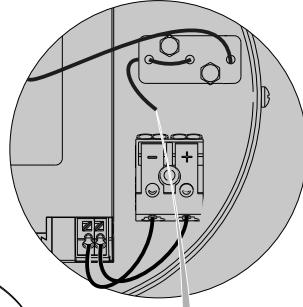
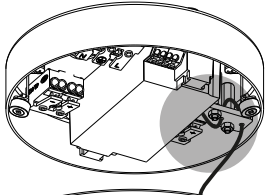

polo positivo
positive pole
Pluspol pole
pôle positif
terminal positivo

conduttore con guaina interno
inner sheathed conductor
Leiter mit innerer Umhüllung
conducteur avec gaine intérieure
conductor con vaina interior

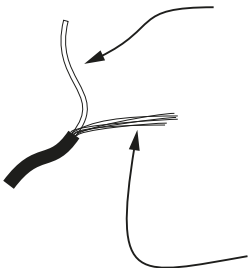

polo negativo
negative pole
Minus pole
pôle négatif
terminal negativo

rivestimento esterno
outer jacket
Außenbeschichtung
revêtement extérieur
revestimiento exterior

A07S37W
A07S55W
A07S11W

A07S37
A07S55
A07S11

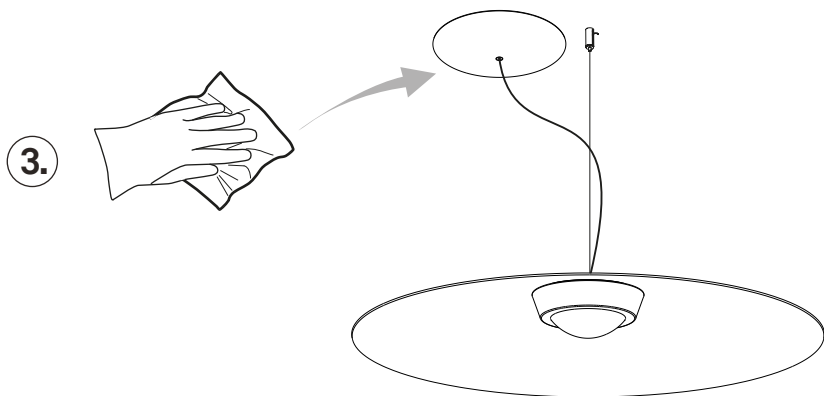
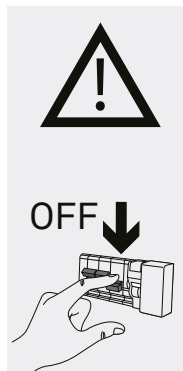
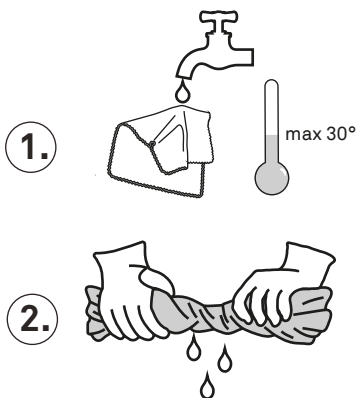

A07F86W
A07F11W
A07F86
A07F11

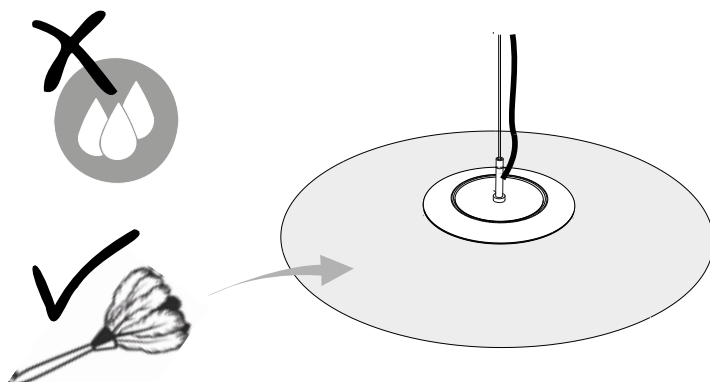

ECODESIGN

SYMBOL LEGEND

LEGENDA DEI SIMBOLI

ERLÄUTERUNG DER SYMBOLE

LEGENDE DES SYMBOLES

LEYENDA DE LOS SIMBOLOS

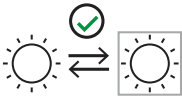

Replaceable light source by end-user
Fonte luminosa sostituibile dal cliente finale
Auswechselbare Lichtquelle durch den Endanwender
Source lumineuse remplaçable par l'utilisateur final
Fuente de luz reemplazable por el usuario final

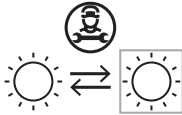

Replaceable light source by a professional
Fonte luminosa sostituibile da un professionista
Auswechselbare Lichtquelle durch einen Fachmann
Source lumineuse remplaçable par un professionnel
Fuente de luz reemplazable por un profesional

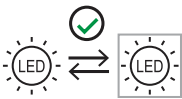

Replaceable (LED only) light source by end-user
Fonte luminosa (solo LED) sostituibile dal cliente finale
Auswechselbare (nur LED) Lichtquelle durch den Endanwender
Source lumineuse remplaçable (LED uniquement) par l'utilisateur final
Fuente de luz reemplazable (sólo LED) por el usuario final

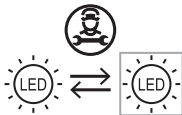

Replaceable (LED only) light source by a professional
Fonte luminosa (solo LED) sostituibile da un professionista
Auswechselbare (nur LED) Lichtquelle durch einen Fachmann
Source lumineuse remplaçable (LED uniquement) par un professionnel
Fuente de luz reemplazable (sólo LED) por un profesional



Non-replaceable light source
Fonte luminosa non sostituibile
Nicht austauschbare Lichtquelle
Source lumineuse non remplaçable
Fuente de luz no reemplazable

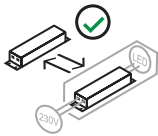

Replaceable control gear by an end-user
Unità di alimentazione sostituibile dal cliente finale
Austauschbares Vorschaltgerät durch einen Endanwender
Pièce d'alimentation remplaçable par l'utilisateur final
Unidad de alimentación reemplazable por el usuario final

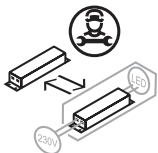

Replaceable control gear by a professional
Unità di alimentazione sostituibile da un professionista
Austauschbares Vorschaltgerät durch einen Fachmann
Pièce d'alimentation remplaçable par un professionnel
Unidad de alimentación reemplazable por un profesional

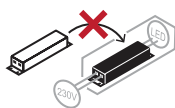

Non-replaceable control gear
Unità di alimentazione non sostituibile
Nicht austauschbares Vorschaltgerät
Pièce d'alimentation non remplaçable
Unidad de alimentación no reemplazable





www.luceplan.com

A070I0001